



Star I – 36397

Star is a modern classic among lamps – the perfect representative for designer Jonas Bohlin’s maxim, “function, innovation and personality”. Star works equally well as a single source of light or as part of a larger constellation arranged in straight lines or circles.

Specification

TECHNICAL SPECIFICATION

Design	Jonas Bohlin
Electrical data	Class I IP20 230V (hard-wired) Class II IP20 230V (cord)
Description	No switch when hard-wired
Connection	3 m textile cord with dimmer and plug or terminal block 3x2.5 mm ² with option for further extensions
Mounting	Cord or hard-wired
Light source	1x5W E14 LED
Weight	1 kg
Volume	0,01 m ³
Care	Download Care Instructions
Recycling	Download Recycling Manual

ARTICLE NO. & MODEL

36397-01-000	White RAL 9016. Housing. White cord with dimmer
36397F01-000	White RAL9016. Housing. Hard-wired
36397-15S-000	Black structure RAL 9005. Housing. Black cord with dimmer.
36397F15S-000	Black structure RAL 9005. Housing. Cord with dimmer.
36397-69-000	Rough copper. Housing. Black cord with dimmer
36397F69-000	Rough copper. Housing. Hard-wired
36397-70-000	Nickel-plated brass. Housing. Black cord with dimmer
36397F70-000	Nickelplated brass. Housing. Hard-wired
36397-72-000	Rough brass. Housing. Black cord with dimmer
36397F72-000	Rough brass. Housing. Hard-wired

Dimensions

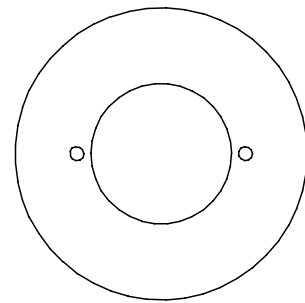

63
ø 105

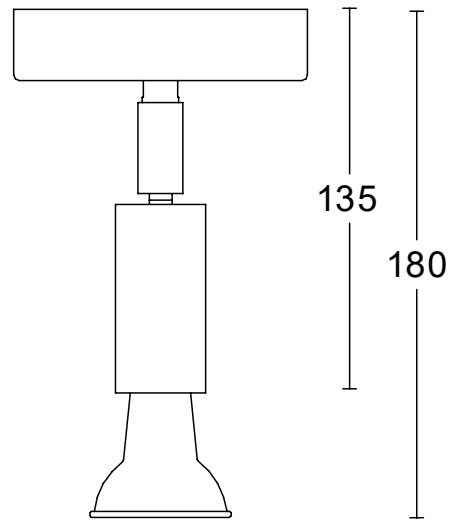

WALL/CEILING LAMP STAR 1